

HAMILTON COUNTY ENGINEER'S

SCOPE OF SERVICE

1. **PROJECT IDENTIFICATION:** WINTON ROAD – PHASE 1

PROJECT No: 509617

Road No: 239

2. **PROJECT LIMITS:** Approximately North Bend Road to North Hill Lane

Length: Approximately 4600 feet

Additional Information: See Additional Information Sheet.

3. **AGREEMENT BETWEEN PROFESSIONAL ENGINEER AND:**

State _____ County XX City _____ Other _____

4. **METHOD OF FINANCING:**

Engineering: County Road and Bridge funds.

Construction: Undetermined at this time.

5. **WORK PHASES INCLUDED IN AGREEMENT:**

PHASE A Plan Submission: Line, grade and typical sections on Base Sheets to be used in final plans. Critical cross sections are to be plotted. Potential design problem areas are to be identified.

PHASE B Plan Submission: To conform to Phase A recommendations. Final review submission is to include Special General Notes and Specifications and quantities.

6. **PLAN SCALES:**

PLAN: 1" = 20' Min.

PROFILE: Hor. 1" = 20' Min. Vert. 1" = 5' Min.

CROSS SECTIONS: Hor. 1" = 5' Min. Vert. 1" = 5' Min.

7. **JOURNALIZED SPEED LIMIT:**

Road Name: 35 MPH

8. TYPICAL SECTIONS/NUMBER OF LANES:

See Corridor Study report completed by Balke Engineers and Additional Information Sheet.

Curbs: YES XX NO _____ Report to Recommend _____

Type: Type 6, Concrete Vertical Curbs

Shoulders/Berms: YES _____ NO XX Report to Recommend _____

Type: _____

Safety Grading Criteria: YES _____ NO XX Partial _____

Guardrail: YES _____ NO XX Type _____

Median: YES _____ NO XX

Clear Zone Grading: YES _____ NO XX

Fencing: YES _____ NO XX

Lighting: YES _____ NO _____

Remarks: Existing lighting to be replaced. Professional Engineer to make recommendation regarding the erection of new lighting.

9. ALIGNMENT:

Existing alignment is to be basically followed.

10. PROFILE:

Existing profile is to be followed as much as possible. Slight adjustments in profile may be required to establish/maintain drainage patterns.

11. SIGNING: YES XX NO _____

Phase A: YES _____ NO _____

Phase B: YES XX NO _____

12. SIGNALS: YES XX NO _____

Phase A: Recommendation _____ Prelim Plan _____

Phase B: YES XX NO _____

Warrants: YES _____ NO _____

13. **STRIPING:** YES NO

Phase A: Recommendation Prelim Plan

Phase B: Final Plan

Type Thermoplastic near North Bend Road, paint in other areas.

14. **DELINEATION:**

Delineators: YES NO

RPMs: YES NO

15. **DRAINAGE:**

Drainage Criteria: State County Public Works

Other

Phase A Preliminary Plan: YES NO

Existing: Surface Closed

Proposed: Surface Closed

Storm water Pollution Prevention Plan: YES NO

Flood Plain Study Required: YES NO

Channel Change Study Required: YES NO

Remarks: Professional Engineer is to determine if additional runoff will cause problems in immediate downstream areas. This will mean in the first section of existing pipe to which a connection is made OR in the open flow areas to the first major culvert.

16. BRIDGE CROSSINGS:

Number of Bridges: None

Cross Roads: _____

Streams: _____

Supplemental Site Plan for Streams: YES _____ NO _____

Culverts: YES _____ NO _____

Alternates Required: YES _____ NO _____

Railroads: _____

Railroad Location Plan: YES _____ NO _____

Railroad Site Plan: YES _____ NO _____

Pedestrian: _____

Mass Transit: _____

Other: _____

17. MISCELLANEOUS DESIGN CONSIDERATIONS:

Bikeways: YES _____ NO XX

Railroads: YES _____ NO XX

Mass Transit: YES _____ NO XX

Service Roads: YES _____ NO XX

18. RETAINING WALLS:

Number of Retaining Walls: None foreseen at this time.

Type(s) of Retaining Walls: _____

Phase A: YES _____ NO _____ Justification _____

Phase B: YES _____ NO _____ Justification _____

19. MAINTENANCE OF TRAFFIC:

Maintenance of Vehicular Traffic: YES XX NO _____

Temporary Road(s): YES _____ NO XX Phase A to Recommend _____

Temporary Road Plans & Notes by: County _____ Professional Engineer _____

Detour Plan Prepared by: County _____ Professional Engineer _____

Remarks: Construction is to be completed under traffic. Professional Engineer is to prepare tentative sequence of construction outline and maintenance of traffic notes in sufficient detail for the proper control of traffic through the project. Items are to be submitted with final review submission.

Maintenance of Pedestrian Traffic: YES XX NO _____

Maintenance of Railroad Traffic: YES _____ NO XX

20. UTILITIES:

Water (XX) Sanitary (XX)

Electric (XX) Gas (XX)

Telephone (XX) Cable TV (XX)

Pub. Works (XX)

Others: _____

Professional Engineer shall contact all Utility Companies and indicate all existing utilities (including house connections) on the plans as required by Section 153.64 O.R.C. (H.B.538). Professional Engineer shall furnish all utilities with a copy of the preliminary plans for preliminary coordination. A copy of the transmittal letters shall be furnished to the County Engineer.

21. ESTIMATED QUANTITIES:

Phase A: YES _____ NO XX

Phase B: YES XX NO _____

Quantity Splits: YES _____ NO XX

22. CONSTRUCTION COST ESTIMATE:

Submit with Proposal: YES XX NO _____

Phase A: YES _____ NO XX

Phase B: YES _____ NO XX

26. **GEOTECHNICAL/SUBSURFACE INVESTIGATION:**

State _____ County XX Professional Engineer _____

Other _____

Remarks: Work to be completed as needed. Professional Engineer is to determine and field locate boring locations.

27. **PRIOR STUDIES:** 402 Safety study completed by TEC & Balke Engineers and a corridor study completed by Balke Engineers.

28. **PUBLIC HEARINGS/INFORMATIONAL MEETINGS:**

Type of Hearing Required: Public information meetings are possible.

Professional Engineer's Responsibility: Professional Engineer is to prepare the necessary exhibits and is to attend these meetings if scheduled.

Exhibits: Some plan and profile and preliminary Right-of-way exhibits may be necessary for these meetings.

ADDITIONAL INFORMATION SHEET

WINTON ROAD – PHASE 1

- 1) The project will extend from approximately North Bend Road to North Hill Lane. The project shall begin at the north curb line of North Bend Road and proceed northwardly. The other legs of the intersection are **NOT** to be modified under this project and the Professional Engineer shall design the improvements so as to meet the existing pavement, lane configurations, curbs, etc. of the other legs of the intersection. The project will extend to the north of the North Hill Lane intersection, i.e. the project **WILL** include the improvement of the intersection and will extend northwardly for a distance sufficient to provide adequate transitions from the improvements to the existing pavement.
- 2) As a part of the Phase A report, the Professional Engineer is to obtain and provide enough field and other information for the Engineer to determine the feasibility of proceeding with the full design of all the improvements recommended by the Balke study. The feasibility of constructing the improvements proposed in the Phase A plans will be reviewed by the Engineer with the intention to limit the impacts on the abutting properties, avoid the taking of structures, provide adequate transitions to the existing pavements, etc. Certain components of the improvements proposed in the Balke study may be modified or eliminated in order to achieve these goals.
- 3) As noted above, the Engineer will adjust the limits, scope and extent of the project to be fully designed by the Professional Engineer in Phase B of the design based upon the decisions made in reviewing the Phase A plans.
- 4) The Professional Engineer shall note that, in addition to the public information meetings noted in the Scope, there will be periodic meetings of the Corridor Task force. The Professional Engineer will be required to attend these meetings as scheduled and to provide project updates and preliminary plans at these meetings for discussion and review by the members of the Task Force.
- 5) In all areas where pavement widening is planned, the Professional Engineer shall design the improvements so that each curb lane will have a minimum width of twelve (12) feet and each interior lane, either a turn lane or a through movement, will have a minimum width of eleven (11) feet. The pavement widening section shall conform to the County's standard pavement for a commercial subdivision.
- 6) The entire pavement through the limits of the project shall be resurfaced with a minimum course of one and one-half (1 1/2) inches of Item 404. As part of the Phase A plans and report, the Professional Engineer shall determine if the resurfacing of the pavement to remain in place will require grinding in order to permit this resurfacing without creating undesirable effects, such as loss of curb reveal. As part of the Phase A plans and report, the Professional Engineer shall also designate/recommend those areas where full-depth pavement repair and curb repair or replacement should be considered.
- 7) Springfield Township owns a parcel of property on the east side of Winton Road, in the vicinity of Timber Trail. The Township is currently proposing to develop this property as a public park, Warder Park. The Professional Engineer shall work with the Engineer, the Township and/or the Township's park designer (Mr. Gary Wolnitzek, Human Resources, 990 St. Paul Place, Cincinnati 45206, 513-281-2211) to develop a preliminary plan for improvements that may be necessary to provide and/or improve access to and from the park. The Engineer will then determine the feasibility of including the recommended improvements in this phase of the project.

WINTON ROAD CORRIDOR STUDY RECOMMENDED PLAN

NORTH BEND ROAD INTERSECTION TO TIMBER TRAIL

Balka Engineers for the Hamilton County Engineer's Office
and Springfield Township
August 2001



North

- Proposed Improvements:
- NORTH BEND ROAD TO TIMBER TRAIL
 - Add center turn lane
 - WINTON / NORTH BEND INTERSECTION
 - Add southbound right turn lane
 - Add eastbound left turn lane
 - Lengthen southbound left turn lane
 - Widen westbound approach to align with eastbound
 - ACCESS ROAD

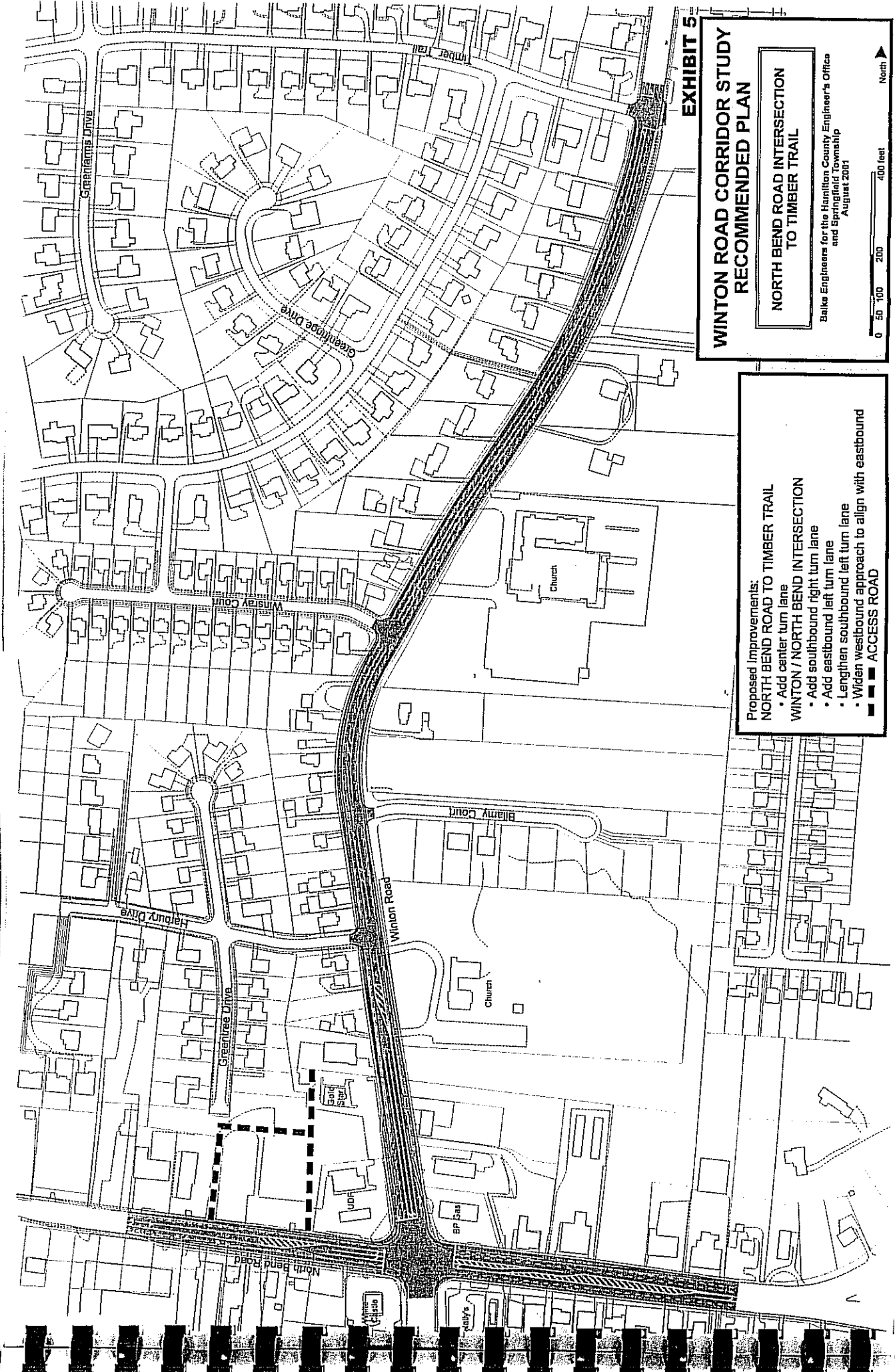

EXHIBIT 6

**WINTON ROAD CORRIDOR STUDY
RECOMMENDED PLAN**

**GALBRAITH ROAD INTERSECTION TO
RONALD REAGAN HIGHWAY**

Balke Engineers for the Hamilton County Engineer's Office
and Springfield Township
August 2001



**Proposed Improvements:
GALBRAITH ROAD / WINTON ROAD INTERSECTION**

- Add southbound left and right turn lanes
- Add northbound right turn lane
- Add westbound left and right turn lanes
- Add eastbound left turn lane

--- ACCESS ROAD

